

▪ **Swing check valves** ▪ **640 AA** ▪ **PN 63-160 (PD 18)** ▪ **DN 50-300/250**

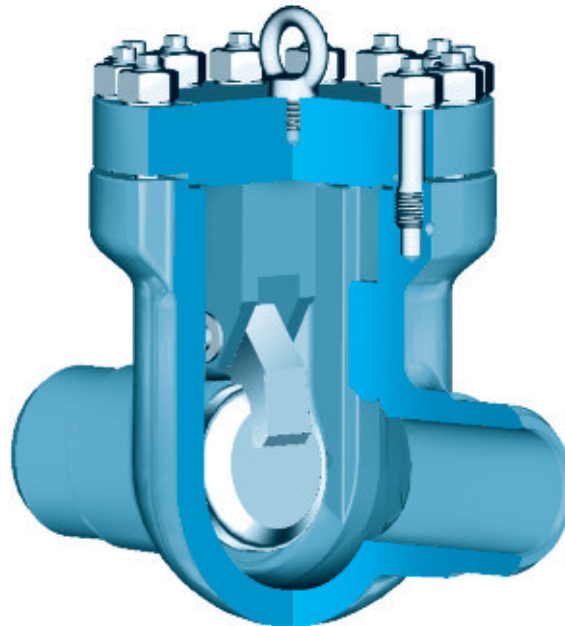

Range of application

FL- Version Material	Admissible operating pressure [bar] at design temperature [°C] ¹⁾																
	PN	-10	20	120	150	200	250	300	350	400	450	500	510	520	530	540	550
1.5415	63	63	63	63	63	63	53	50	47	45	29	22	16	14			
1.7335	63	63	63	63	63	63	63	61	58	56	47	40	32	25	20	15	
1.7383	63	63	63	63	63	63	63	61	58	56	47	40	32	28	24	20	

1) Operating temperature = design temperature minus temperature surcharge acc. to DIN regulations.

FL- Version Material	Admissible operating pressure [bar] at design temperature [°C] ¹⁾																
	PN	-10	20	120	150	200	250	300	350	400	450	500	510	520	530	540	550
1.5415	100	100	100	100	100	100	87	78	74	70	45	34	27	22			
1.7335	100	100	100	100	100	100	100	95	91	87	74	62	49	38	31	24	
1.7383	100	100	100	100	100	100	100	95	91	87	74	62	49	43	37	31	

1) Operating temperature = design temperature minus temperature surcharge acc. to DIN regulations.

FL- Version Material	Admissible operating pressure [bar] at design temperature [°C] ¹⁾																
	PN	-10	20	120	150	200	250	300	350	400	450	500	510	520	530	540	550
1.5415	160	160	160	160	160	160	139	125	118	112	72	55	43	35			
1.7335	160	160	160	160	160	160	160	153	146	139	118	100	79	62	46	35	
1.7383	160	160	160	160	160	160	160	153	146	139	118	100	79	70	61	52	

1) Operating temperature = design temperature minus temperature surcharge acc. to DIN regulations.

BW- Ends Material	Admissible operating pressure [bar] at design temperature [°C] ¹⁾																										
	PD	120	150	200	250	300	350	400	420	430	440	460	470	480	490	500	510	520	530	540	550	560	570	580	590	600	
1.5415	18	219	204	185	170	146	141	136	134	133	132	130	129	128	112	88	67	53	42								
1.7335	18	228	219	205	194	180	170	161	156	155	153	150	149	148	147	133	112	89	72	58	46	37	30				
1.7383	18	233	224	210	205	194	180	170	166	164	262	159	156	155	153	131	115	100	88	76	66	56	50	43	37	33	

1) Operating temperature = design temperature minus temperature surcharge acc. to DIN regulations.

▪ **Swing check valves** ▪ 640 AA ▪ PN 63-160 (PD 18) ▪ DN 50-300/250

Standard features

- Die-forged body
- Disc with inside shaft

Pressure and temperature ratings

- Pressure rating BW-Ends up to 233 bar (PD 18)
- Pressure rating FL up to 160 bar
- Temperature rating up -10° C to +600° C

Materials

- 1.5415
- 1.7335
- 1.7383

Further materials on request

Media

Depending on the material swing check valves are suitable for water, gas, oil and other non aggressive media

Fields of application

Chemical industries, power plants, ship building and other

Design Highlights

- Die-forged body
- Seats welded on integrately with stellite
- Lever rests on the hinge pin by means of the guide bush
- Bolted bonnet with reduced-shaft bolts

Benefits

- Free from porosity and shrink holes
- No crevice corrosion between seat and valve body
- Optimum adjustment of the disc to the body seat by means of the movability the guide bushing of
- To improve the stress capacity when temperature and pressure changes

▪ **Swing check valves** ▪ 640 AA ▪ PN 63-160 (PD 18) ▪ DN 50-300/250

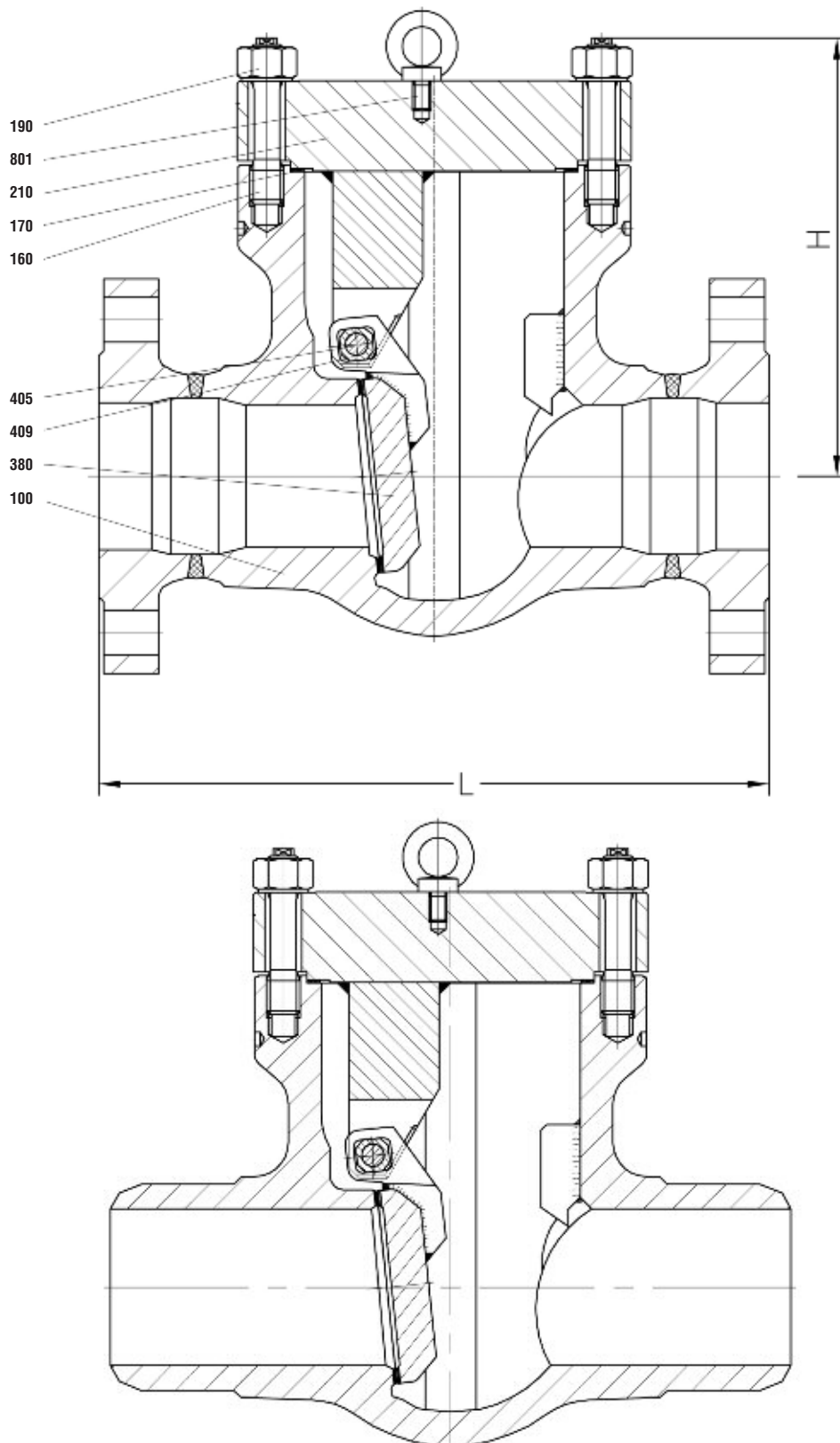

■ **Swing check valves** ■ **640 AA** ■ **PN 63-160 (PD 18)** ■ **DN 50-300/250**

Materials				
Pos.	Component	1.5415 (42)	1.7335 (44)	1.7383 (45)
100	Body welded on with	1.5415	1.7383/1.7335	1.7383
160	▶ Gasket	Stellite	Stellite	Stellite
170	▶ Screw bolt	Graphite	Graphite	Graphite
190	Hexagonal nut	1.7709	1.7709	1.7709
210	Cover	1.7258	1.7258	1.7258
380	▶ Disc welded on with	1.5415	1.7335	1.7383
405	▶ Hinge pin	Stellite	Stellite	Stellite
409	▶ Guide bush	1.4021	1.4021	1.4021
801	Lifting eye bolt	0.7040	0.7040	0.7040
	▶ Spare parts	1.0401	1.0401	1.0401

Dimensions/mm				
DN	PN 63-100 L	PN 160 L	H	D
50	300	300	220	192
65/50	340	360	220	192
80	380	390	280	236
100	430	450	320	265
125/100	500	525	320	265
150	550	600	410	350
200	650	750	510	440
250	775	900	595	550
300/250	900	1050	595	550

Weights/kg		
DN	Flange	BW
50	45	35
65/50	53	43
80	83	63
100	105	100
125/100	111	106
150	270	220
200	425	365
250	525	750
300/250	610	800