

▪ **Globe valves** ▪ High pressure globe valve HD 91 ▪ 200 JM ▪ PN 320 ▪ DN 10-65/50

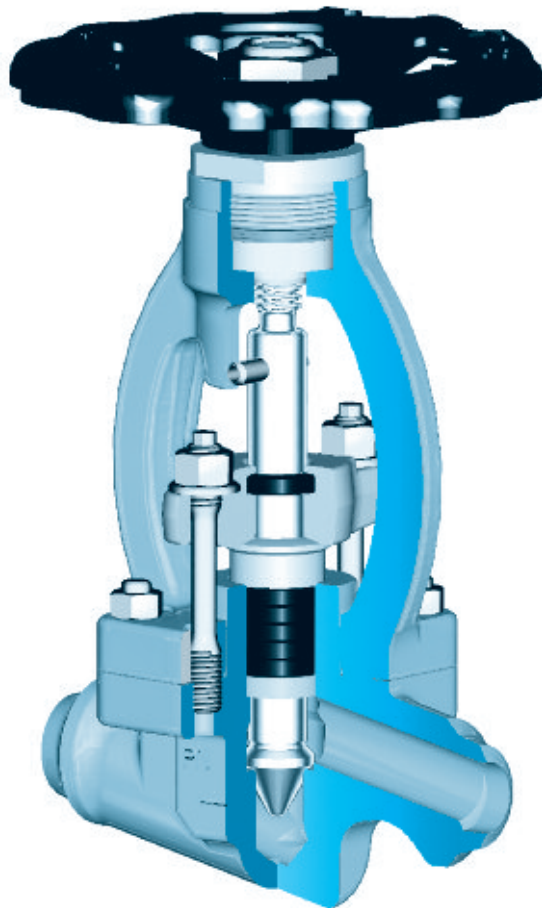

Range of application

Admissible operating pressure [bar] at design temperature [°C] ¹⁾

Material	PN	-10	20	50	100	120	150	200	250	300	350	400	410	420	430	440	450	460	470	480	490	500	510	520	530	540	550	560	570	580 ²⁾	590 ²⁾	600 ²⁾	
1.5415	160	192	192	192	192	192	192	179	165	141	137	132	131	130	129	128	127	126	125	124	109	85	64	51	41								
	250	300	300	300	300	300	300	280	258	221	213	206	205	203	202	200	199	197	196	194	170	132	101	79	64								
	320	320	320	320	320	320	320	320	320	283	273	264	262	260	258	256	255	253	251	249	217	170	129	102	81								
1.7335	160	192	192	192	192	192	192	189	174	165	156	154	152	150	148	146	145	144	143	142	129	109	86	70	57	44	36	29					
	250	300	300	300	300	300	300	294	272	258	243	240	237	234	231	228	227	225	224	222	202	170	134	109	88	69	57	46					
	320	320	320	320	320	320	320	320	320	311	307	304	300	296	292	290	289	287	285	287	258	217	172	140	113	88	72	59					
1.7383 ²⁾	160	192	192	192	192	192	192	189	174	165	163	161	159	157	156	154	152	150	143	127	111	97	85	74	64	55	48	41	36	32			
	250	300	300	300	300	300	300	294	272	258	255	252	249	246	243	240	237	234	224	199	174	152	132	115	100	85	75	65	56	49			
	320	320	320	320	320	320	320	320	320	320	319	315	311	307	304	300	287	255	223	194	170	147	128	109	96	83	72	63					

1) Operating temperature = design temperature minus temperature surcharge acc. to DIN regulations.

2) For temperatures > 570° C, high-temperature-packing.

■ **Globe valves** ■ High pressure globe valve HD 91 ■ 200 JM ■ PN 320 ■ DN 10-65/50

Standard features

- Die-forged valve body and bonnet
- Disc and stem in one piece with stellite edge seat
- Non-turning, rising stem
- Position indicator
- Gland flange and gland ring in two separate pieces
- Yoke sleeve made of bronze

Pressure and temperature ratings

- Pressure rating up to 320 bar
- Temperature rating from -10° C up to +600° C

Materials

- 1.5415
- 1.7335
- 1.7383

Further materials on request

Media

Depending on the material the globe valves are suitable for water, gas, oil and other non aggressive media

Fields of application

High temperature steam and water, Refining (Catalytic reformers and Hydrocrackers), Petrochemical and Chemical Industries

Design-Highlights

- Body and bonnet in two separate pieces with bolted connection
- Body seat: edge seat welded on integrally with stellite
- Yoke sleeve (in closing direction) supported by needle bearings (axial type)
- Sealing to the outside only means of the gland packing
- Gland flange with wiper ring

Benefits

- To ease maintenance work, e.g. regrinding of the body seats
- No pressed in or screwed seat ring, therefore no crevice corrosion or loosening
- To minimize the expenditure of effort when closing valve
- No bonnet gaskets, therefore reduction of possible leakage areas
- Prevents dirt from entering the moving thread section

▪ **Globe valves** ▪ High pressure globe valve HD 91 ▪ 200 JM ▪ PN 320 ▪ DN 10- 65/50

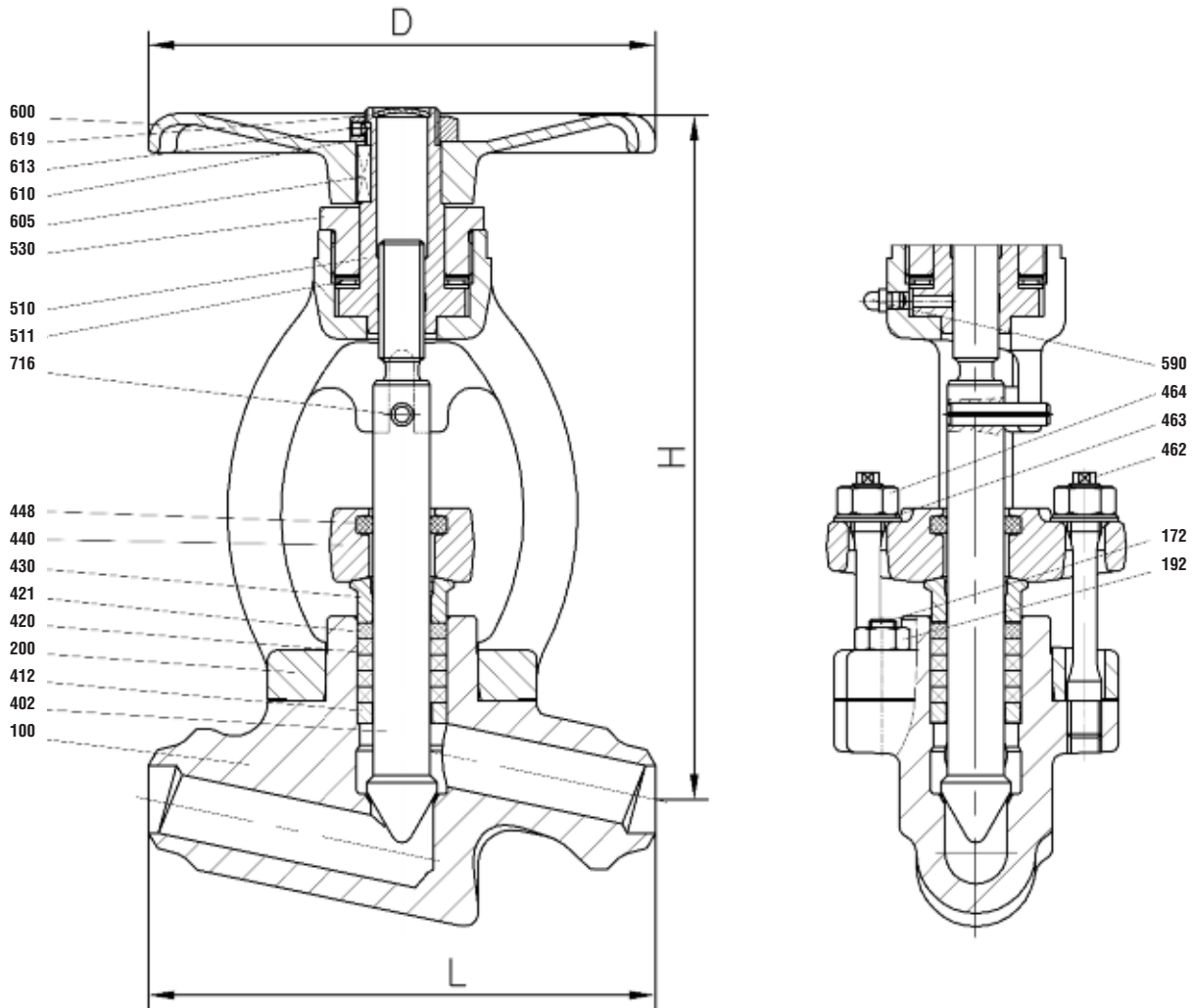

■ **Globe valves** ■ High pressure globe valve HD 91 ■ 200 JM ■ PN 320 ■ DN 10- 65/50

Materials

Pos.	Component	1.5415 (42)	1.7335 (44)	1.7383 (45) ²⁾
100	Body	1.5415	1.7335	1.7383
	welded on with	Stellite	Stellite	Stellite
172	Stud	1.7709	1.4923	1.4923
192	Hexagonal nut	1.7258	1.4923	1.4923
200	Bonnet	1.7383	1.7383	1.7383
402	▶ Stem with throttle disc	1.4122	1.4923	1.4923
	welded on with	inductive hardened	Stellite	Stellite
412	Guide sleeve	0.7670	0.7670	0.7670
420	▶ Packing	Graphite	Graphite	Graphite ²⁾
421	▶ Ring	Graphite Plait	Graphite Plait	Graphite Plait
430	Gland ring	1.5415	1.5415	1.5415
440	Gland flange	1.7383	1.7383	1.7383
448	▶ Dirt Scraper	Graphite	Graphite	Graphite
462	Stud	1.7709	1.4923	1.4923
463	Washer	St	St	St
464	Hexagonal nut	1.7258	1.7258	1.7258
510	▶ Yoke sleeve	CW 713 R ¹⁾	CW 713 R ¹⁾	CW 713 R ¹⁾
511	▶ Bearing	WLS	WLS	WLS
530	Yoke nut	1.0718	1.0718	1.0718
590	Grease nipple	5.8	5.8	5.8
600	Handwheel	0.7040	0.7040	0.7040
605	Key	1.0060	1.0060	1.0060
610	Hexagonal nut	St	St	St
613	Screw pin	45H	45H	45H
619	Lock washer	St	St	St
716	▶ Tension pin	1.0904	1.0904	1.0904
	▶ Spare parts			

1) On request: GGG 40 respectively Ni-Resist.
2) For temperatures > 570° C, hightemperature-packing.

Dimensions/mm

DN	L	H	Stroke	R/Stroke	D
10	150	205	12	6	140
15	150	205	12	6	140
20	180	245	18	6	180
25	180	245	18	6	180
32 ¹⁾	300	370	30	10	280
40	300	370	30	10	280
50	300	370	30	10	280
65/50	300	370	30	10	280

1) DN 32 not included in the DIN-Standard.

Attention: In case of welding connentions the permissible operating overpressure is valid for the corresponding tube dimensions.

Weights/kg and Kvs-values

DN	BW-Ends	Zeta (DN rel.)	Kvs (m3/h)
10	4,5	3,0	2,3
15	4,3	7,0	3,4
20	8,4	4,5	7,5
25	8,2	6,9	9,5
32	27,5	6,1	16,6
40	27,0	10,2	20,0
50	26,8	9,7	32,0
65/50	26,8	7,8	32,0